

# - TOM HASSAN -

604.809.9777 tom@tomhassan.com  
 Royal LePage Sussex www.tomhassan.com

1319 Fulton Avenue,  
 West Vancouver, B.C.

Main Floor: 1,215 sq.ft.  
 Upper Floor: 323 sq.ft.  
 Lower Floor: 1,066 sq.ft.

**Total: 2,604 sq.ft.**

Restricted H.R.: 233 sq.ft.  
 Crawl Spaces: 144 sq.ft.

### Auxiliary Area

Carport\*: 244 sq.ft.  
 Decks: 253 sq.ft.  
 Garage Storage: 167 sq.ft.  
 Storage Shed: 79 sq.ft.

\*CARPORT SQ.FT. AND DIMENSIONS ARE APPROXIMATED

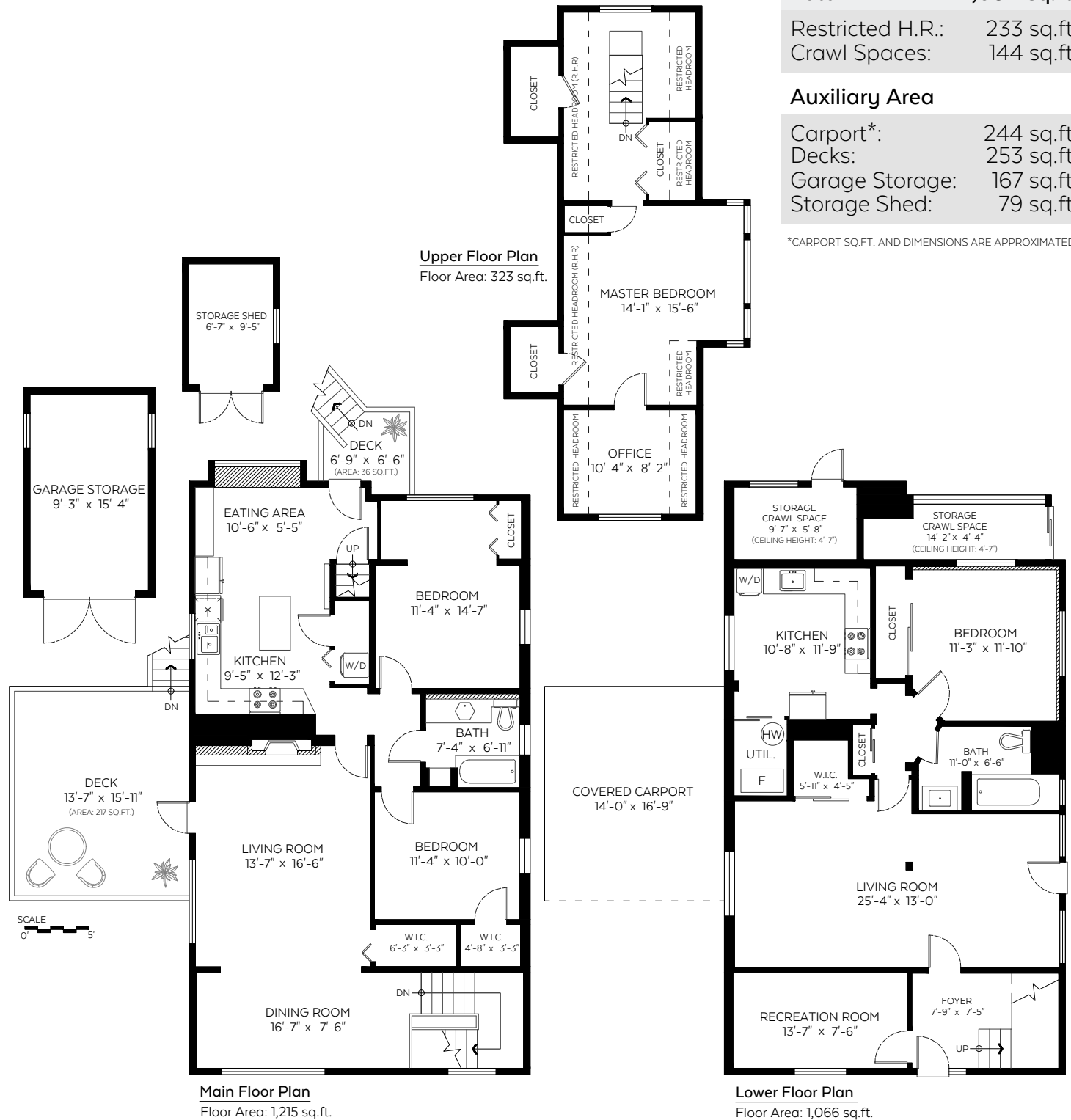

**Main Floor Plan**  
 Floor Area: 1,215 sq.ft.

**Upper Floor Plan**  
 Floor Area: 323 sq.ft.

**Lower Floor Plan**  
 Floor Area: 1,066 sq.ft.



Valid Until: October 27, 2021

The floor plan is not suitable for architectural/construction and is covered under E&O. © Excelsior Measuring Inc. 2019. All rights reserved for Excelsior Measuring Inc. Users shall not publish and distribute such material (in whole or in part) and/or incorporate it in other works in any form.



Booked on  
 the Pixilink App™

