

**PLAN SHOWING THE LOCATION OF IMPROVEMENTS SITUATED UPON  
 LOT 1, BLOCK 3, DISTRICT LOT 578, PLAN 8683.  
 MUNICIPALITY OF NORTH VANCOUVER.**

SCALE 1: 250 (METRIC)

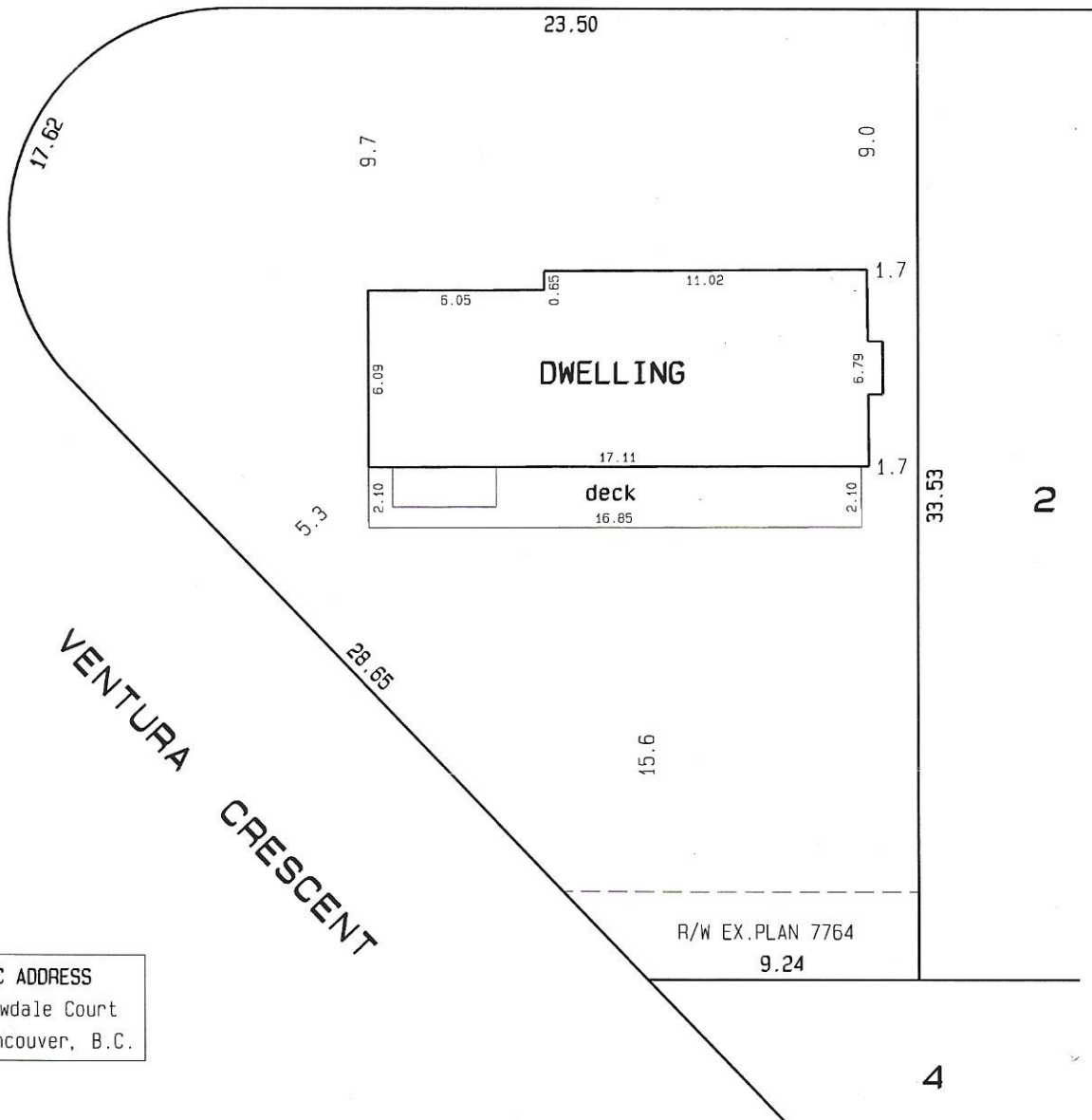

**NEWDALE COURT**



**CIVIC ADDRESS**  
 #415 Newdale Court  
 North Vancouver, B.C.

*CERTIFIED CORRECT AS TO LOCATION  
 AND DIMENSION OF IMPROVEMENTS*

*D. Prokopetz, ASCT, RSIS*

DATED THIS 8th DAY OF JANUARY, 2010.

NOTE: The location of features certified by this plan has been determined from existing survey monumentation and does not purport to be a location certified in relation to a boundary of land. We accept no responsibility for the unauthorized use or for any use of a copy not bearing an original embossed seal. Property line dimensions are according to Land Title Office records. This plan is not to be used for the re-establishment of property lines. This plan is to be used for mortgage purposes only.

**Westcoast Surveys Ltd.**

16264 80th Avenue  
 Surrey, B.C. V4N 0X3  
 tel 604-543-8665 fax 604-543-8610  
 faxdon@gmail.com  
 Our File: 1-12-10  
 Your File: Strong/Mitsui