

865 Inglewood Ave.
W. Vancouver, BC

Main Level: 1708 sq. ft.
Lower Level: 1438 sq. ft.
Total: 3146 sq. ft.
Lower Level: 256 sq. ft. (Unfinished)
Grand Total: 3402 sq. ft.

Tom Hassan

604.809.9777

tom@northshorehome.ca
www.northshorehome.ca

Other Areas: (not included in total)
Garage: 575 sq. ft.
Deck: 370 sq. ft.

LOWER LEVEL
Area: 1438 sq. ft. (Fin.)
Area: 256 sq. ft. (Unfin.)

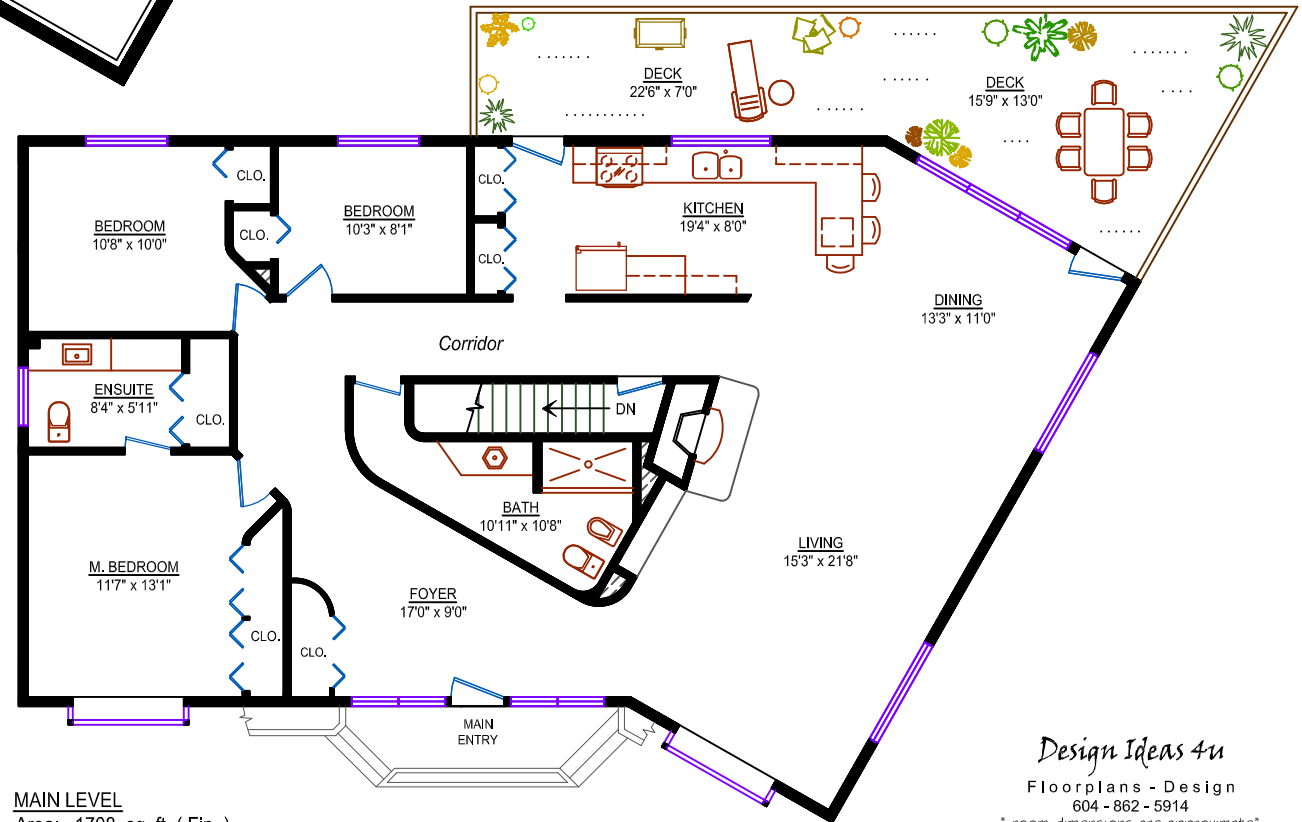
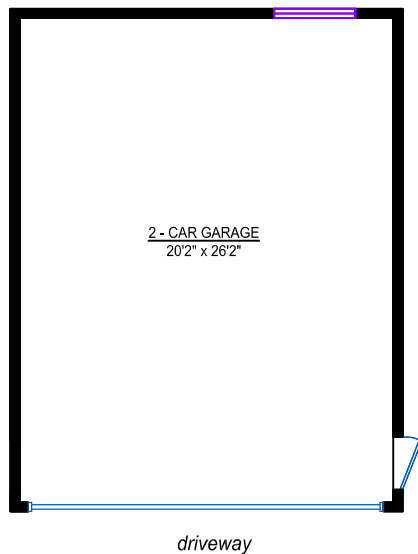
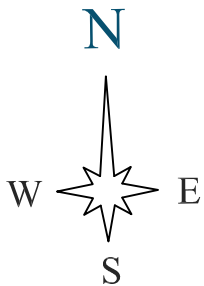
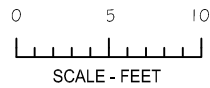

MAIN LEVEL
Area: 1708 sq. ft. (Fin.)

Design Ideas 4u
Floorplans - Design
604 - 862 - 5914
* room dimensions are approximate*