

- TOM HASSAN -

604.809.9777 tom@tomhassan.com
Royal LePage Sussex www.tomhassan.com

#32-2246 Folkestone Way,
West Vancouver, B.C.

Main Floor: 1,200 sq.ft.

Ceiling Height: 8 ft.

Auxiliary Area

Balcony: 248 sq.ft.

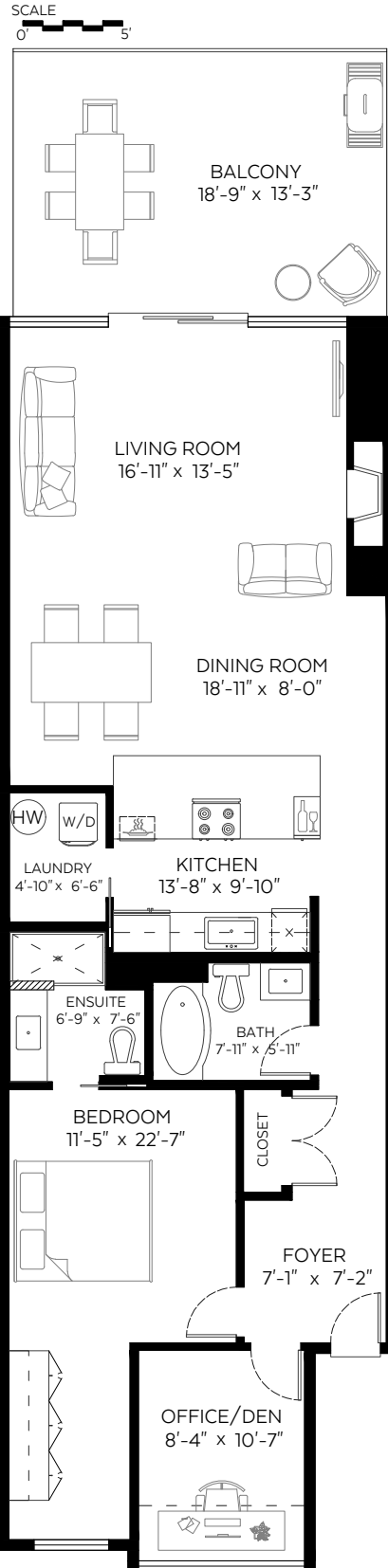

Valid Until: July 8th, 2023



The floor plan is not suitable for architectural/construction and is covered under E&O. © Excelsior Measuring Inc. 2022. All rights reserved for Excelsior Measuring Inc. Users shall not publish and distribute such material (in whole or in part) and/or incorporate it in other works in any form.



NORTH

Booked on
the Pixlink App™



- TOM HASSAN -

604.809.9777
Royal LePage Sussex

tom@tomhassan.com
www.tomhassan.com

MEASUREMENTS

#32-2246 Folkestone Way,
West Vancouver, B.C.

Property Type: Condominium

Valid Until: July 8th, 2023

Main Info.



Main Floor 1,200 sq.ft.

Total 1,200 sq.ft.

Main Floor

FOYER	7'-1"x7'-2"
OFFICE/DEN	8'-4"x10'-7"
BEDROOM	11'-5"x22'-7"
ENSUITE	6'-9"x7'-6"
BATH	7'-11"x5'-11"
LAUNDRY	4'-10"x6'-6"
KITCHEN	13'-8"x9'-10"
DINING ROOM	18'-11"x8'-0"
LIVING ROOM	16'-11"x13'-5"



604.510.1299 | www.excelsiorlevel.com | team@excelsiorlevel.com

The floor plan is not suitable for architectural/construction and is covered under E&O. © Excelsior Measuring Inc. 2022. All rights reserved for Excelsior Measuring Inc. Users shall not publish and distribute such material (in whole or in part) and/or incorporate it in other works in any form.